

ENERGOHOUSE

ECONOMICAL LIVING

& RENEWABLE ENERGY

SENSE



Welcome to ENERGOHOUSE!

Imagine a house that is controlled from any part of the world. Systems and appliances supervised future home that works for you. The use of renewable energy sources, solar systems, wind turbines, natural water purification.

Intelligent Houses, Modern and Maritime Containers builded according to your idea.

Build what you want, you can create any space with the possibilities we have.

WELCOME TO THE WORLD OF HOME AUTOMATIZATION SYSTEM

Currently, the FIBARO System is the best building automation solution available on the world market. The purpose of this presentation is to give at least a brief overview of the possibilities it offers. The number of solutions and practical applications of the FIBARO System is so vast that no instruction manual or book could present them all. With the FIBARO System the sky is the limit. The remaining sections of this presentation outline the most important premises behind the FIBARO System and give you an idea of what you can expect upon installing it in your house or apartment. The FIBARO System is a totally new approach to intelligent building automation solutions. The FIBARO System is more than just an intelligent electrical system. It is a trusted host, FIBARO interface for iPad, your personal manager who will take care of you and your family. Not only the FIBARO System will ensure your comfort, but it will also change your life – try it and things will never be the same again.





ACEROTECHNOLOGY

The Unique Technology in the world without limits and limitations. LONG-term durability and structural STABILITY. Unlimited space and construction options. Guarantee your SPACE without undue restrictions. Live in the castle as a KING and at the same time be at home with ACEROTECHNOLOGY.

ACERO CUBE TECHNOLOGY

We build modular homes from shipping container. Our modular houses are 100% customizable. To the modular system our constructions have a great versatility, being able to relocate and expand the house adapted to the needs of customers at all times. The short delivery times, the quality control of materials and mass production make the metal houses a wise choice of great quality at an unbeatable price. We put at your disposal the most avant-garde construction technique with the highest quality.

VENTILATED FACADE

A specially designed wall system allows the walls to breathe, ultra-sophisticated design tailored to your home, a channel ventilation system that prevents moisture from penetrating into your walls.

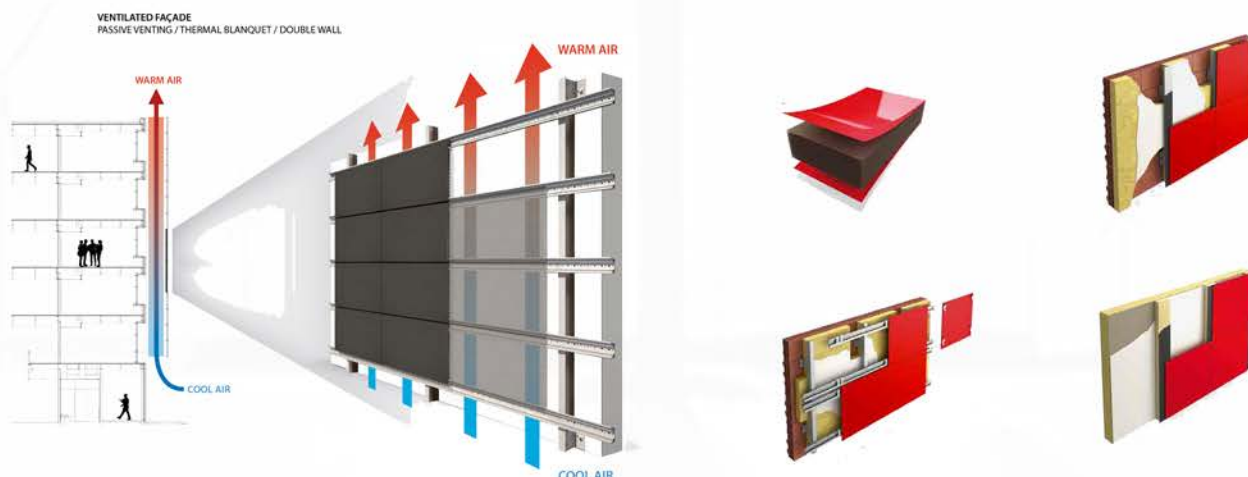



MODERN HOUSES

ACERO TECHNOLOGY



ACERO TECHNOLOGY by ENERGOHOUSE is one kind of possibilities to make your house stronger than concrete, flexible like metal, clear like glass. Complet metal construction for flexible stability. Concrete walls for hard component with integrated modern prefabricated technologies for interior confort and exterior future design. Protect your house for your future, against humidity an other possible pitfalls that can attack your home.

Interior design by your imagination, architects with many years experiences, the top quality of materials and system style in architecture, the interior design and décor service formed in association with architects, all these characteristics create a compact system that ensures perfect interior design. All items are carefully selected to redefine internal paces with uniquely selected items of the highest quality sourced from around the world. You have to admit, when someone has style, this is obvious to everyone.



ENERGOHOUSE was founded in 2008 by the sole purpose of being able to offer clients a seamless design from the exterior through to the interior spaces. The team of interior architects ensure that the interiors are designed and detailed to complement the overall appearance of the design.

Their scope of work includes the detailed design and specification of all interior elements including: kitchen, bathrooms, staircases, lighting, custom designed cabinetry, cupboards, ceilings, flooring and wall finish. It is of utmost importance to the architectural firm as a whole that the interior and exterior of its designs are seen as one, and through ENERGOHOUSE, clients get an effective transition between the two.



LUXURY MODULAR HOUSES

ACERO CUBE TECHNOLOGY



ACERO CUBE TECHNOLOGY FOR YOUR FUTURE LIVING

Think about the house more stronger and flexible then concrete with unlimited spaces. ACERO CUBE by ENERGOHOUSE is one kind of possibilities to make your house stronger than concrete, flexible like metal, clear like glass. Protect your house against humidity an other future possible pitfalls that can attack your house. Multiple configurations out a single technology

ACERO CUBE TECHNOLOGY FOR YOUR FUTURE RESTAURANT

It would allow us to scale our production, improve our build quality and lower our prices and lead-times, without compromising on design. Strong of years of experience in container modification we have developed a system which allows for multiple configurations out a single unique Base modul ©.



ACERO CUBE TECHNOLOGY FOR YOUR FUTURE BUSINESS

ENERGOHOUSE Base modul © has over ten years experience designing and manufacturing the best shipping container workshop you'll ever see. Aussie tough and fully guaranteed. Strong of years of experience in container modification we have developed a system which allows for multiple configurations out a single unique Base modul ©.



SYSTEMS



Thermal Insulation - Sustainable Quality of Life

Optimised heat level can be reached in all types of buildings and consequently sustainable and improved buildings can provide fuel saving.



Fire Protection - Stay on Safe Side

Knauf ETICS provides fire protection by it's non-combustible properties. It can protect your building in accordance with standards.



Load Bearing Capacity - Solid and Enduring

With a layer of proper plaster thickness, you can protect your building against the external impacts.



Weather Protection - No place for moss

Weather conditions are the major factor of façade deformations. ETICS helps to prevent moss on façades and leaves no space for extra precautions.



Design Variety - Freedom of Façade Design

From now on, there's no limit on façades. With our brand new product Sandstone, you can give natural stone appearance and protect your building from weather conditions at the same time.



Sound Insulation - Perfect Silence

Optimised sound insulation can raise quality of live. Protect your living space with Knauf ETICS systems.



Stable Value

There are too many good reasons to choose Knauf ETICS. One of the most important reasons is it's high resistance. Knauf ETICS provides long-term protection and aesthetic appearance.

INTERIOR WALL SYSTEMS

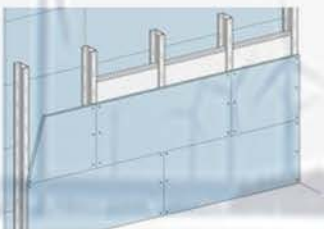

K131 Safeboard Partition Wall System

K131 Safeboard partition wall system, which is X-ray protection wall, is installed with single DC stud, 12,5 mm single layer Safeboard on each side and proper thickness of mineral wool according to the width of DC stud.

› K131

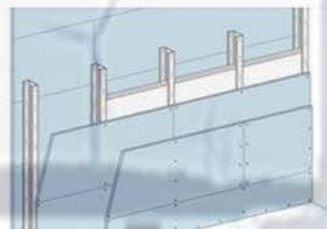

K132 Safeboard Partition Wall System

K132 Safeboard Partition Wall System, which is X-ray protection wall, is installed with single DC stud, 12,5 mm double layer Safeboard on each side and proper thickness of mineral wool according to the width of DC stud.

› K132

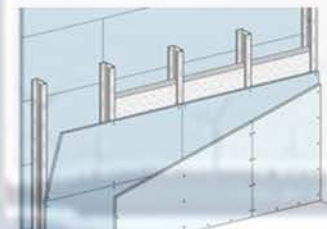

K132D Safeboard + Diamant Partition Wall System

K132D Safeboard partition wall system, which is X-ray protection wall, is installed with single DC stud, 12,5 mm single layer Safeboard and 12,5 mm single layer Diamant on each side and proper thickness of mineral wool according to the width of DC stud.

› K132D

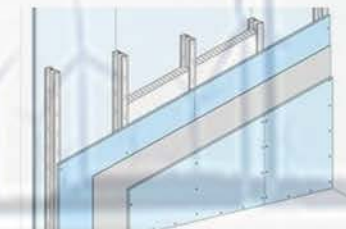

W118 WK2 Diamant Partition Wall System

W118 WK2 partition wall system is a safety wall, installed with single DC stud, at least 12,5 mm thick double layer Diamant Board on each side, 0.50 mm thick steel sheet between the boards and with proper thickness of thick mineral wool according to the width of DC stud.

› W118 WK2

Fixings

Knauf Drywall Screws are self drilling and self tapping, and designed to work perfectly with Knauf Plasterboard.



Head Track

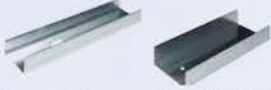

Knauf 'U' Channel used with Knauf 'C' Studs.

Knauf 'UW' Channel for use with Knauf 'MW' Studs

Studs

Knauf metal studs simply twist and snap into head and floor tracks.



Knauf 'C' Stud lightweight steel section.

Knauf 'MW' Stud for improved acoustics.

Insulation

Knauf Earthwool Acoustic Roll used to improve the acoustic performance.



Jointing

Knauf Uniflott used to fill joints and screw heads without the need for tapes.



Finish with a coat of Knauf Joint Cement Easy Sand.



Floor Track

Knauf 'U' Channel.

Knauf 'UW' Channel for use with Knauf 'MW' studs.



Knauf Silentboard

Knauf Silentboard offers superior sound insulation.

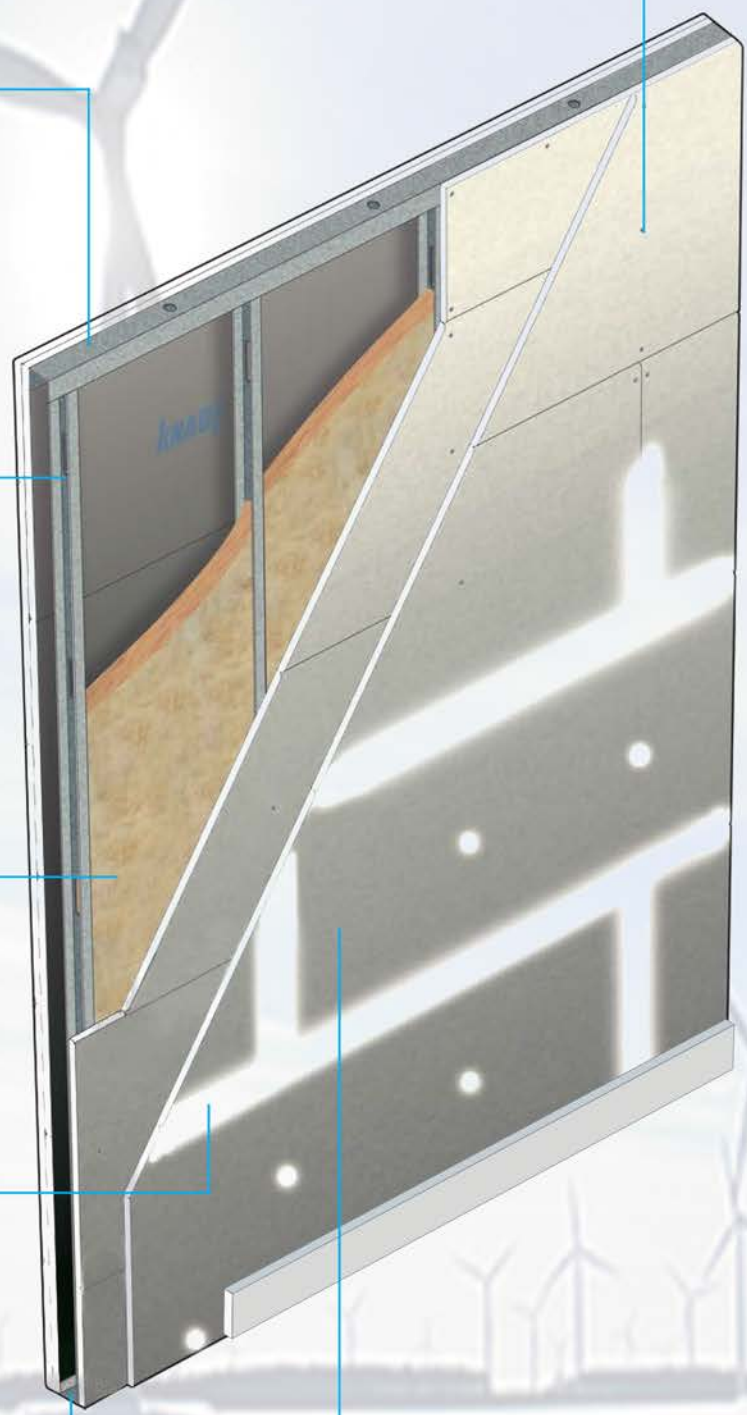



ECONOMICAL LIVING & RENEWABLE ENERGY

Av. Madroñal 22
38660 Costa Adeje
Tenerife, Spain

mobil: 0034 635 913 881
email: spain@energohouse.eu

www.energohouse.es
www.energohouse.eu
www.energohouse.co.uk
www.energohouse.de
www.energohouse.fr
www.energohouse.sk
www.energohouse.cz